

# arcoPlus® 613

Modular panel of U.V. PROTECTED alveolar polycarbonate for insulated **traslucide** windows

arcoPlus®613 is a modular system commonly used in civil and industrial buildings, for new buildings as well as for maintenance and restoration operation. It consists of coextruded triple wall polycarbonate panels with a "N" structure, and thickness of 3/8 in, with a groove and tongue joint.

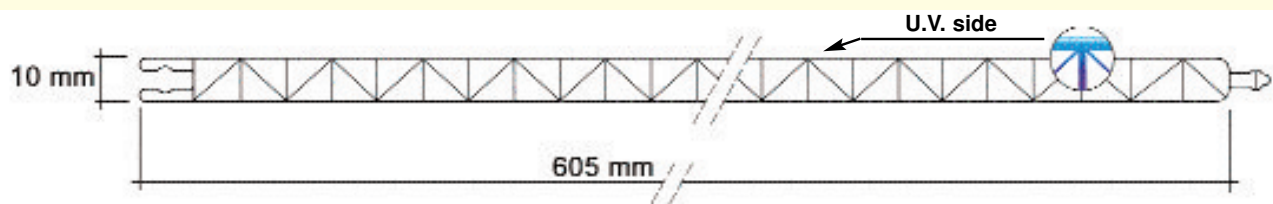

## SPECIFICATIONS

Vertical installation and ceiling installation made with modular multiwall coextruded polycarbonate panels with external UV rays protection, thickness 3/8 in on complete section. Thermal transmission coefficient  $K = 2,7 \text{ W/m}^2\text{K}$ , obtained through air chambers within the panel (minimum 2).

## EASY AND LOW-COST INSTALLATION

The triple wall design with "groove and tongue joint" and the 3/8 in thickness give the panel remarkable resistance in bending and it allows panel set up without a metal reinforcing frame (continuous windows) in order to eliminate the heat loss due to thermal bridges caused by the structure frame (discontinuous windows). The panels can be supplied without U.V. protection (velario®613).

### PRODUCTION STANDARDS

Thickness	3/8"
Structure	3 walls
Modular width	23.819"
Panel length	No limits

### TECHNICAL FEATURES

Thermal transmittance	$U = 0.475$ ; $R = 2.11$	
Linear thermal expansion	1/8" per 3' per 100°	
Use temperature	-40°F +248°F	
UV rays protection	COEXTRUSION	
Fire reaction	ASTM D-635-98: ZERO (0)	

Colour	Light transmission	Solar Factor
Satin Cryst.d	76%	76%
Satin Opá	58%	65%

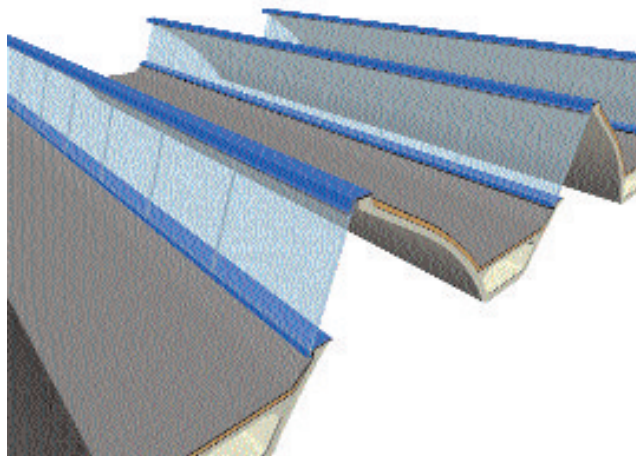

DETAIL PANEL JOINT



## "STRONG POINTS"

- EASY AND LOW-COST INSTALLATION
- **AUTOPORTANT**
- LIGHT TRANSMISSION SOLAR FACTOR
- RESISTANCE TO UV RAYS AND TO HAIL
- THERMAL ISOLATION  
(See section "general characteristic of product" pag.6/7)

Fermeture alvéoles :  
Thermosoudure Cod. 4226  
Pose bande alu pleine Cod. 4225

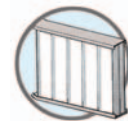

The below mentioned values are referring to the installed product second the described prescriptions in the Technical Handbook.

## ADMITTED DISTANCES

on two supports

Grâce au tableau ci-dessous, on peut individualiser la distance des appuis

▲ ▲	ADMITTED DISTAN-
CES	
Load 80 (daN/mq)	

COLOUR	cod.
arcoPlus® 613	
Satin Cryst.d	2141/5028

# arcoPlus<sup>®</sup> velario<sup>®</sup> 613

Modular panel of UNPROTECTED alveolar polycarbonate for ceilings and movable walls

arcoPlus<sup>®</sup>613 Velario is a modular system commonly used in civil and industrial buildings, for new buildings as well as for maintenance and restoration operation. It consists of **unprotected** polycarbonate panels having triple wall with a "N" structure, and thickness of 3/8 in, with a groove and tongue joint.

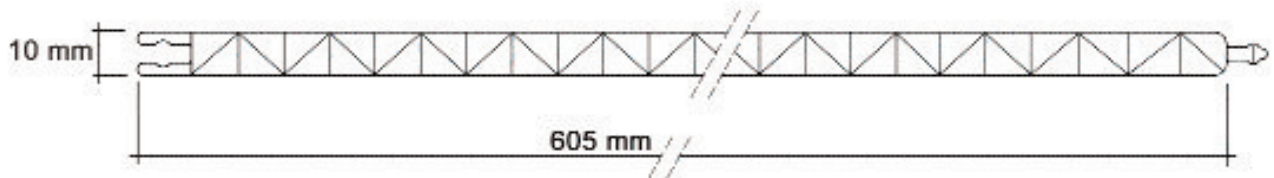

## SPECIFICATIONS

Ceiling installation made with modular multiwall unprotected polycarbonate panels, thickness 3/8 in on complete section. Thermal transmission coefficient  $K=2,7 \text{ W/m}^2\text{K}$ , obtained through air chambers within the panel (minimum 2).

## EASY AND LOW-COST INSTALLATION

The triple wall design with "groove and tongue joint" and the 3/8 in thickness give the panel remarkable resistance in bending and it allows panel set up without a metal reinforcing frame (continuous windows) in order to eliminate the heat loss due to thermal bridges caused by the structure frame (discontinuous windows). The panels can be supplied with U.V. protection (arcoPlus<sup>®</sup>613).

### PRODUCTION STANDARDS

Thickness	3/8"
Structure	3 walls
Modular width	23.819"
Panel length	No limits

### TECHNICAL FEATURES

Thermal transmittance	U = 0.475; R = 2.11	
Linear thermal expansion	1/8" per 3' per 100°	
Use temperature	-40°F +248°F	
UV rays protection	COEXTRUSION	
Fire reaction	ASTM D-635-98: ZERO (0)	
Colour	Light transmission	Solar Factor
Satin Crystal	76%	76%

## "STRONG POINTS"

- EASY AND LOW-COST INSTALLATION
- **AUTOPORTANT**
- LIGHT TRANSMISSION
- THERMAL ISOLATION  
(See section "general characteristic of product" pag.6/7)

Fermeture alvéoles :  
Thermosoudure Cod. 4226

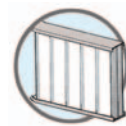

The below mentioned values are referring to the installed product second the described prescriptions in the Technical Handbook.

## ADMITTED DISTANCES

Grâce au tableau ci-dessous, on peut individualiser la distance des appuis.

	ADMITTED DISTANCES
CES	
Load 80 (daN/mq)	

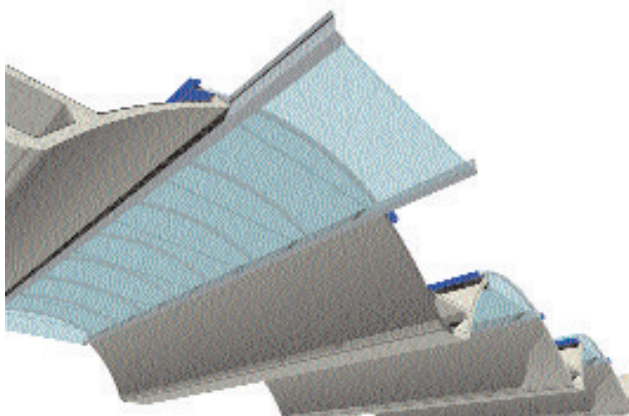

### DETAIL PANEL JOINT



COLOUR	cod. Velario <sup>®</sup> 613
Satin Crystal	2141/5028nuv
Satin Opal	2141/5015nuv